

# Attachment A

## Specifications Contact:

Lindsey Nietmann  
lindsey.nietmann@hawaii.gov

## Container Lab Office Specifications

40' by 16' Office/Lab Space

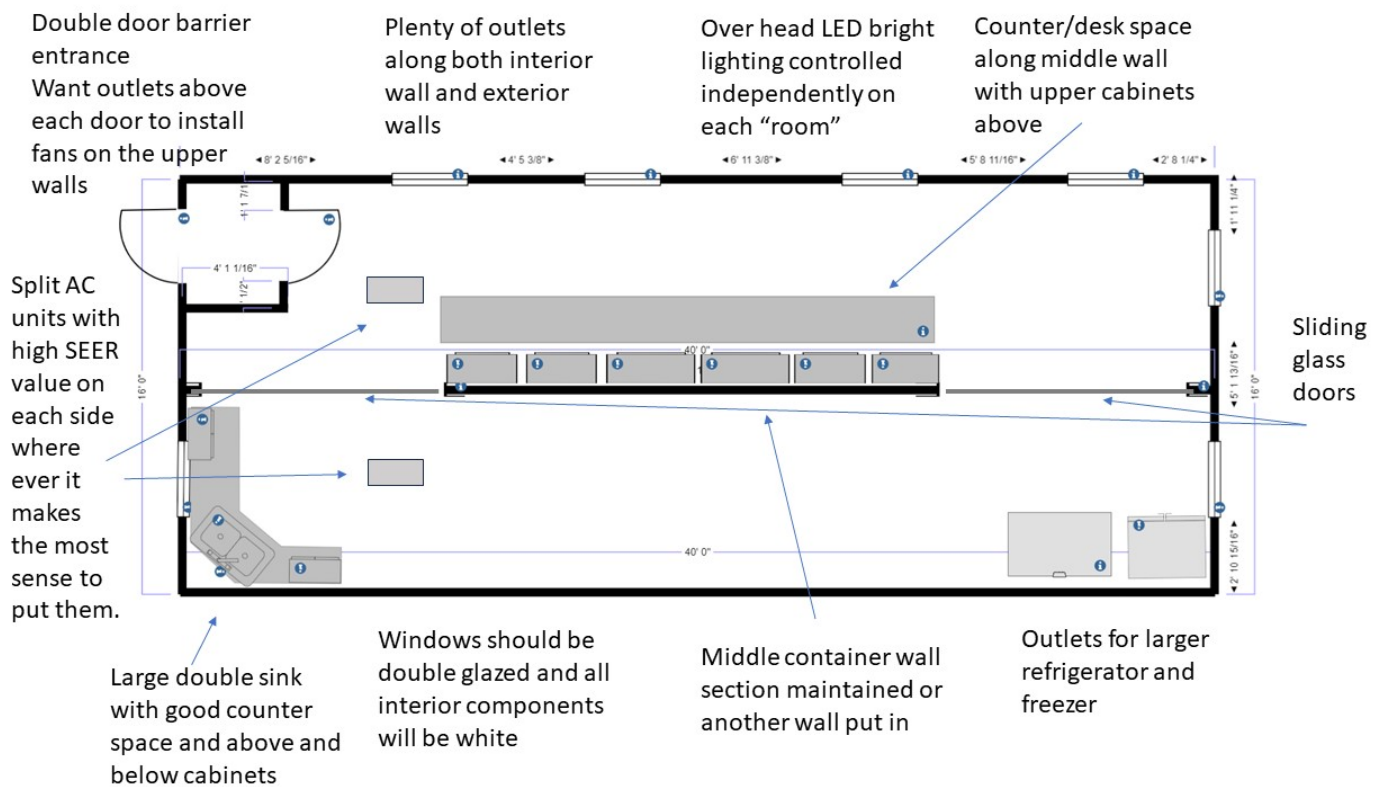

## Solicitation Description:

The State of Hawaii Department of Land and Natural Resources, Division of Forestry and Wildlife requests bids for one 40' x 16' custom office/lab container building to be used for unpacking *Culex quinquefasciatus* mosquitoes prior to release as part of the Incompatible Insect Technique (IIT) plan to suppress mosquito populations that transmit deadly diseases to endangered forest birds. This space will also be used for QA/QC work, mosquito ID, larval growing, and office space.

The office container must have 2 rooms (see the schematic with glad door and container wall separations). There must be a 36" wide external door double entrance. The walls must be finished with drywall and insulation and the floor will be commercial high traffic vinyl tile. There must be 2 mini-split AC units. There must be one large double sink in the lab and very bright LED overhead lighting in each room. The electricity must be set up so that it can be plugged into the grid or an off-grid solar panel and battery system with outlets along all walls. Similarly, the plumbing for the sink must be set up so that it can connect to regular water lines or can be ran on an off-grid water tank and pump system. The only build in counters and cabinets will be upper cabinets above a desk height workbench along the office side of the middle partition and bottom and top cabinets around the sinks with good counter space. Sliding glass doors will close off the two sides of the building in the middle wall. All glass will be double glazed. Placement of other doors, windows, and AC units in the floorplan is approximate and can be adjusted unless specified in the line items below.

All line item prices for the office container provided by the vendor must include shipping to Maui and delivering to a site with easy truck access in Paia. This solicitation will include 19 line items:

1. 2- 40' x 8' one-trip containers (or 4 20' x8' one-trip containers)
2. 1 ½" steel studs w/ R13 Insulation walls and ceiling, drywall with texture and paint
3. Elastomeric silicone roof coating
4. Exterior painted with 2 part epoxy marine grade paint
5. Polyurethane caulk on doors and windows
6. Industrial grade zinc coating applied to all weld points
7. Drywall ceiling same as the wall in #2 with 3 ½" studs for thicker insulation
8. Commercial (high traffic) vinyl tile flooring
9. Electrical panel with space for all outlets and appliances outlets (Needs to be solar with ability to connect to conventional electrical power)
  - a. 3 prong outlets (2 outlets per) in the office part installed between 3.5-4ft high above the work bench/desk and at normal heights along each wall.
  - b. 3 prong outlets (2 outlets per) in the lab part installed at normal heights along each wall
  - c. Outlets in the middle zone between the double entrance above doors for wall mounted fans
10. 2- Single zone 12k mini split AC units; 1 in each room
11. 8- LED lights with switches by the doors
12. 1- Partition retained container wall with two interior sliding glass doors to divide container into two rooms.
13. 1- Large capacity double stainless steel laboratory sink with detachable sprayer faucet compatible with external water tank/pump system (both hot and cold water accessible) plumbed through the wall
14. 1- 36" outswing steel external door - fire rated hollow core with steel jam
15. 1- 36" steel external door that swings inward- fire rated hollow ore with steel jam (doors keyed differently)
16. At least 7 double-pane double glazed windows with screens that can slide or hinge open
17. 2- Steel Entry Doors 3' x 6'8"
18. 2- Sliding glass doors 8' 6'8"
- 19. Delivery to Holomua Rd. Paia HI 96779 ASAP, hopefully December 2023, no later than February 2024**